



 PARCEL SEVEN ASSOCIATES, L.L.C.
 TORTI GALLAS AND PARTNERS, INC.

8TH AND H STREETS NE

Revised May 13, 2009



Alley (South) Elevation



Revised West Elevation



Before



Note - Increased setback of upper floors from adjacent townhomes.

©2009 Torti Gallas and Partners, Inc. | 1300 Spring Street, 4th floor, Silver Spring, Maryland 20910 301.588.4800

View looking east on H Street, NE

Revised May 13, 2009



Note - Increased setback of upper floors from adjacent townhomes.

©2009 Torti Gallas and Partners, Inc. | 1300 Spring Street, 4th floor, Silver Spring, Maryland 20910 301.588.4800

View looking North on 8th

Revised May 13, 2009



©2009 Torti Gallas and Partners, Inc. | 1300 Spring Street, 4th floor, Silver Spring, Maryland 20910 301.588.4800

View looking North on 10th Street

Revised May 13, 2009



Note - Residential garage ramp relocated to be accessed off alley, and plan has been updated to show separate residential lobbies for Phase 1 & Phase 2

©2009 Torti Gallas and Partners, Inc. | 1300 Spring Street, 4th floor, Silver Spring, Maryland 20910 301.588.4800

First Floor Plan

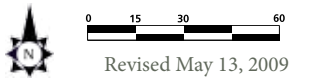



©2009 Torti Gallas and Partners, Inc. | 1300 Spring Street, 4th floor, Silver Spring, Maryland 20910 301.588.4800

2nd - 4th Floor Plans

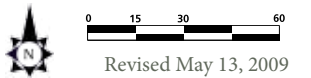



©2009 Torti Gallas and Partners, Inc. | 1300 Spring Street, 4th floor, Silver Spring, Maryland 20910 301.588.4800

6th Floor Plan (5th and 7th Floor Plans Similar)

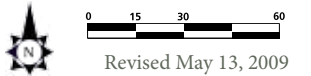

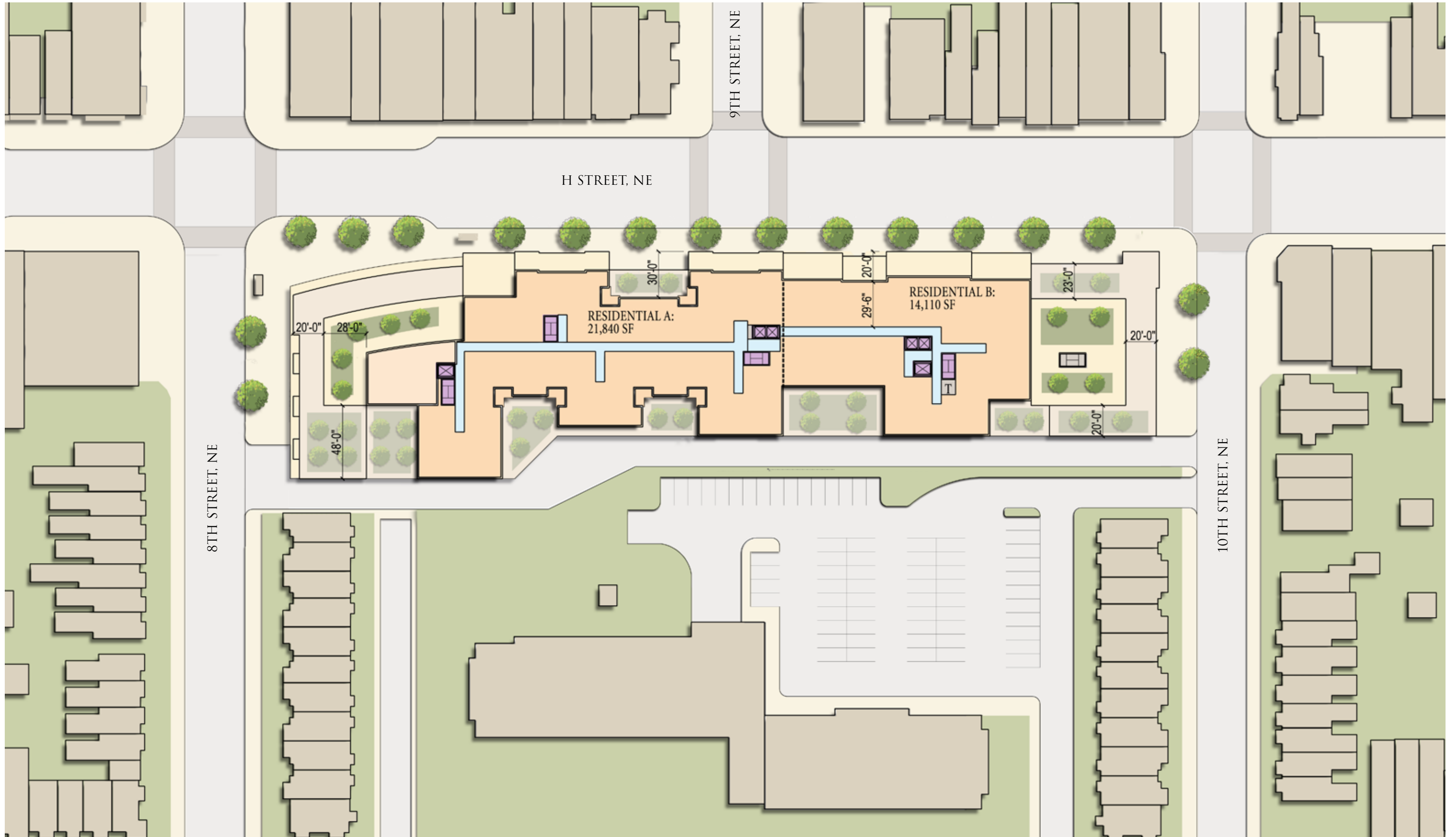

©2009 Torti Gallas and Partners, Inc. | 1300 Spring Street, 4th floor, Silver Spring, Maryland 20910 301.588.4800

8th Floor Plan

