

Envision Courthouse Square

CONCEPT A

Courthouse Square

DRAFT Design Concepts

July 23, 2014
Community Workshop 3

Concept A

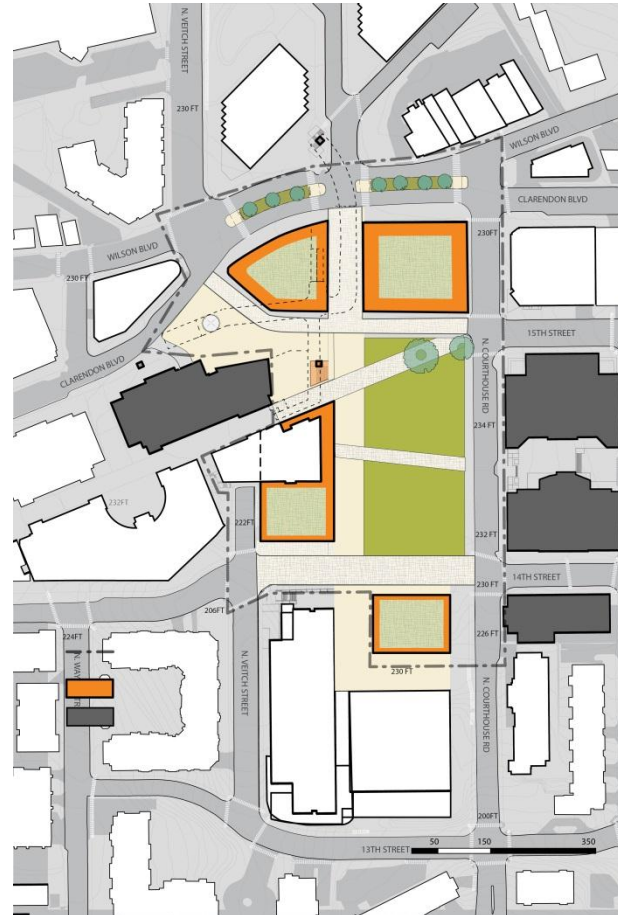

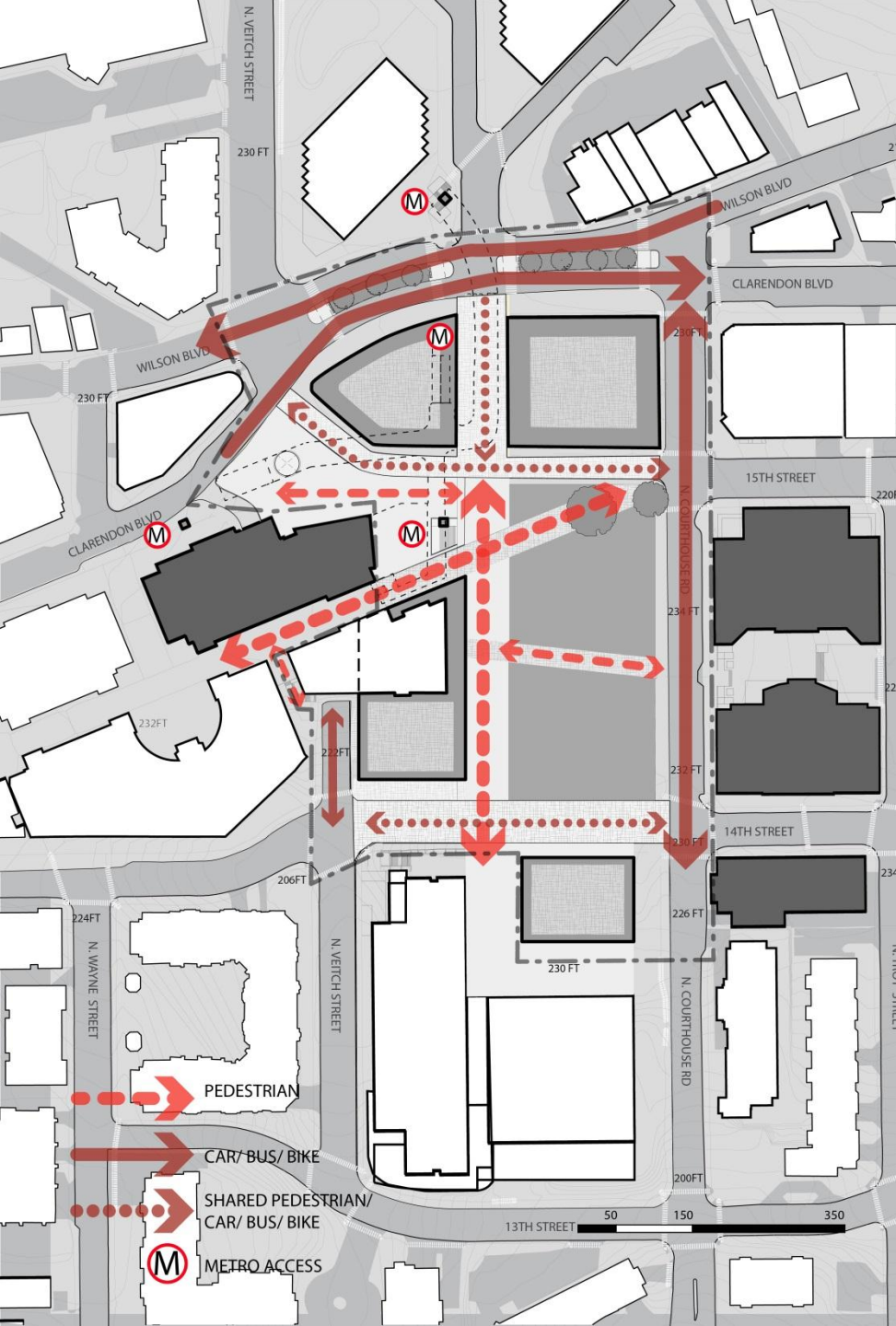

Concept A

Circulation

- 15th Street
 - Option for arrival skylight on ‘pork chop’ and 15th
 - Option for closure from Clarendon to Uhle
 - Metro arrival in front of 2100 Clarendon on Square

- Uhle Street
 - Nature of street between 15th St. and 14th St.
 - Nature of street between Clarendon Blvd. and 15th St.
 - Pedestrian promenade, vehicular, or shared

- 14th Street/Veitch Street
 - Nature of street between Courthouse Road and Veitch St.
 - Road Diet

- Wilson/Clarendon Boulevards
 - Narrow boulevards, consider median and sidewalk widths



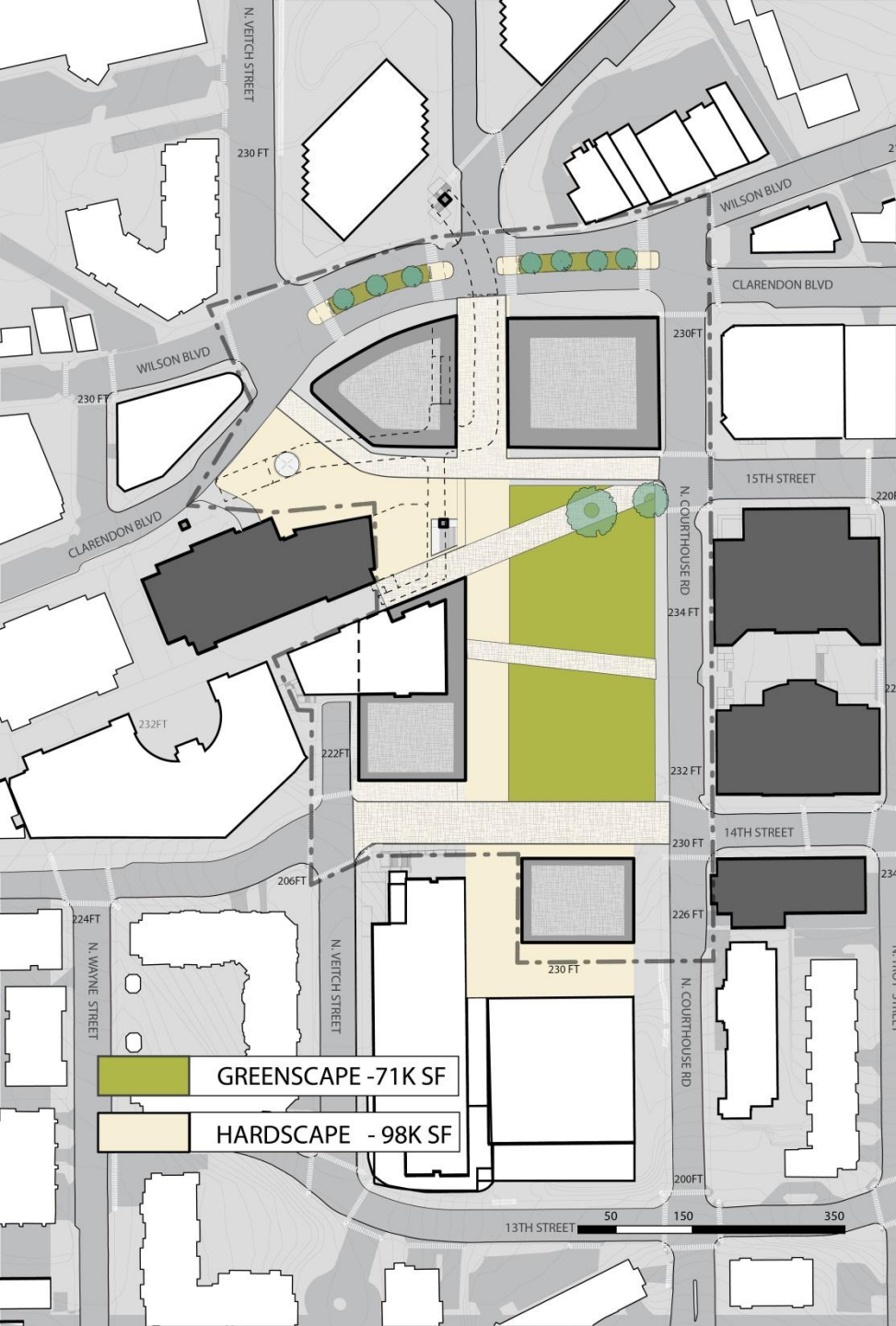

Concept A

Open Space

- Option for arrival skylight on 'pork chop' and 15th
- Option for arrival/entry plaza in front off 2100 on Square
- Uhle Street Promenade
- Nature of primary open space – Lawn/trees, hardscape/softscape, formal/passive?

Concept A

3.9 acres

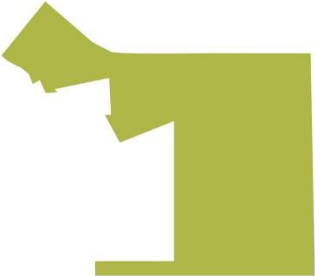



Eastern Market, Washington D.C.



Flexible use of space; balance of hardscape & landscape, Klyde Warren Park, Dallas, TX



River Market, Kansas City, MO



Discovery Green, Houston, TX



Concept A

Buildings

- A. Strayer Block – Private development
- B. Landmark Block – Private development (with significant height?), façade preservation option
- C. Verizon Plaza Site – County Building with cultural facility option or private development
- D. AMC/Court Square West Site – Private development, liner retail in front of AMC



Concept A

Active Frontage and Access

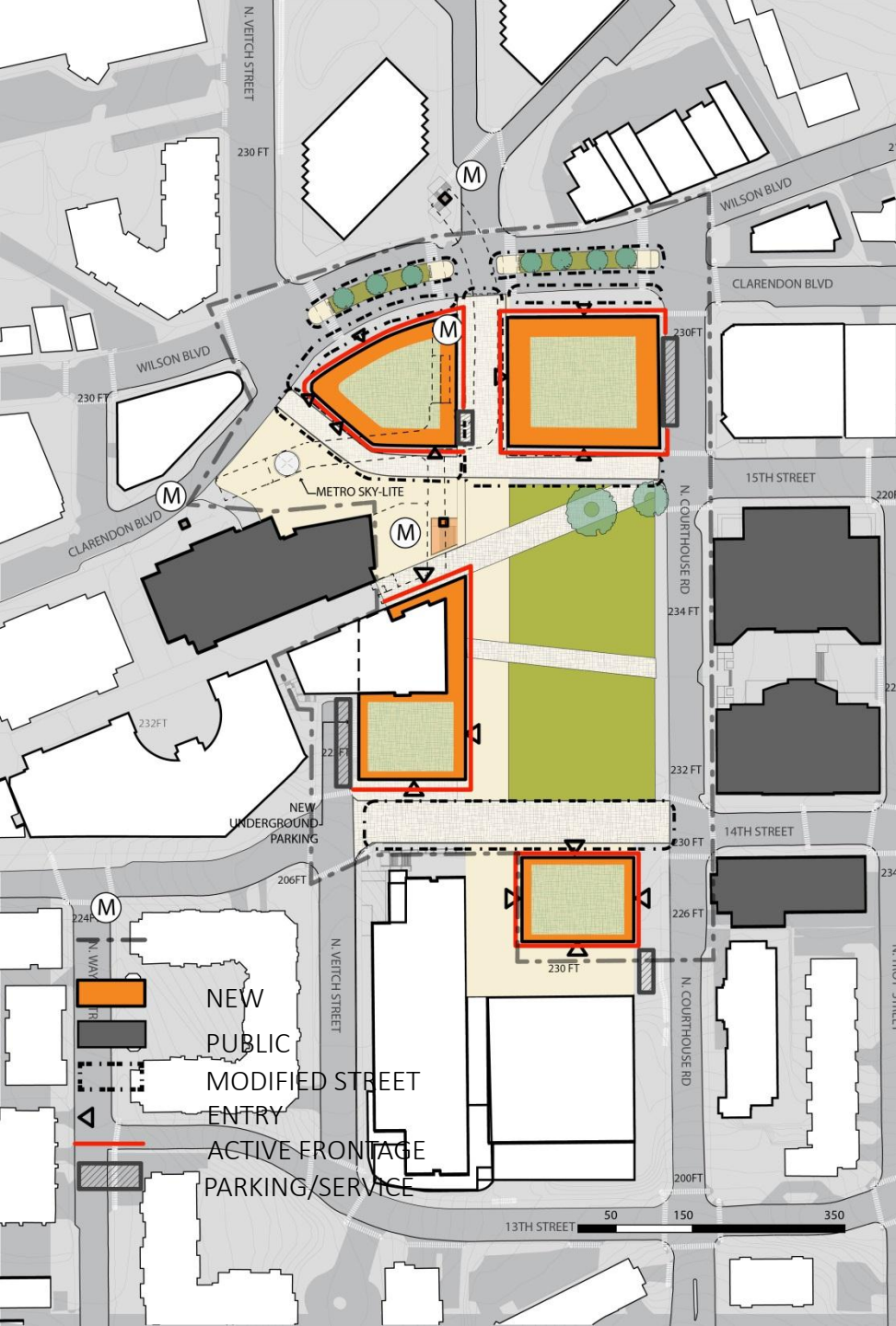

COURTHOUSE SQUARE CONCEPT A

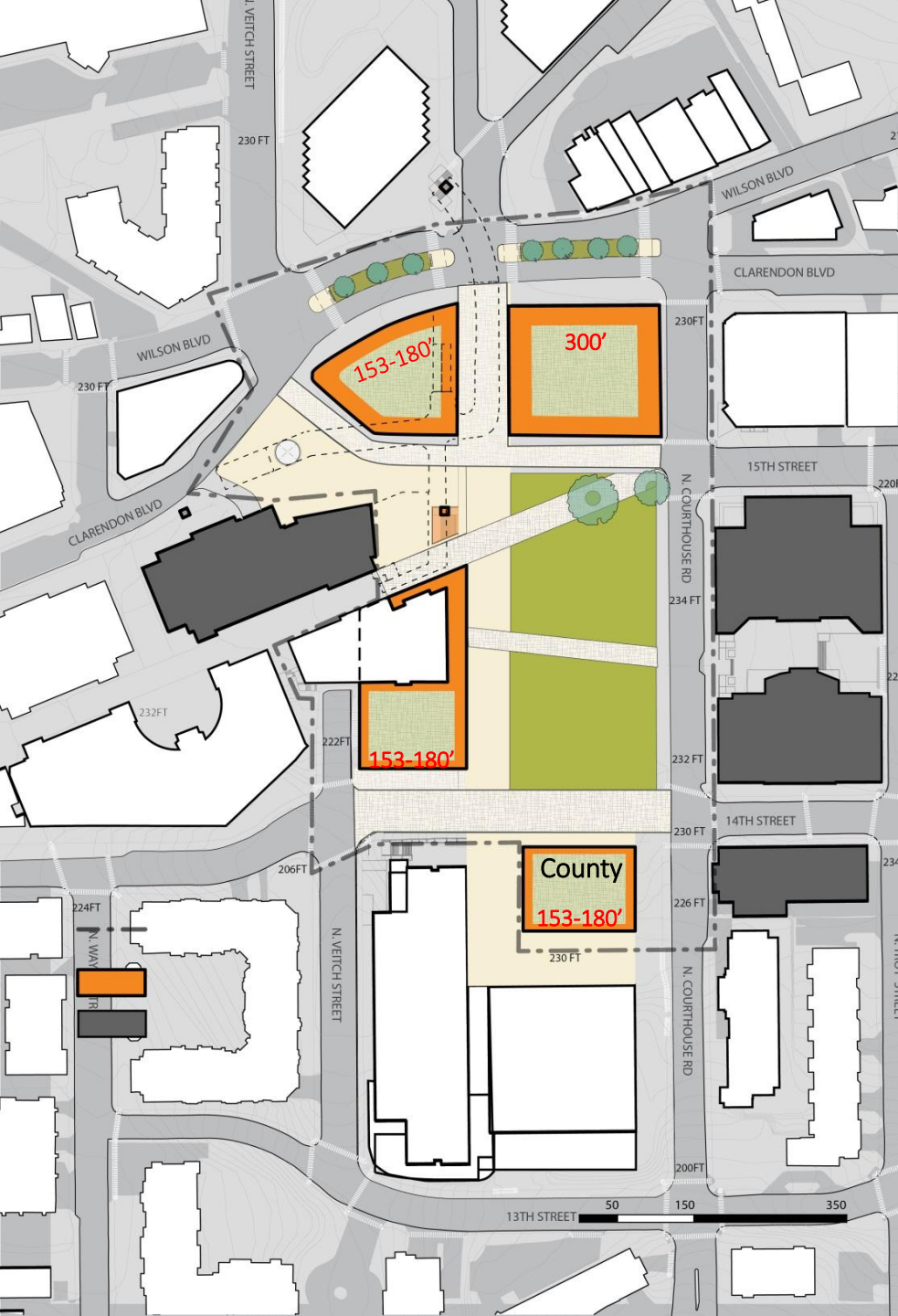

Envision Courthouse Square

NEXT STEPS